

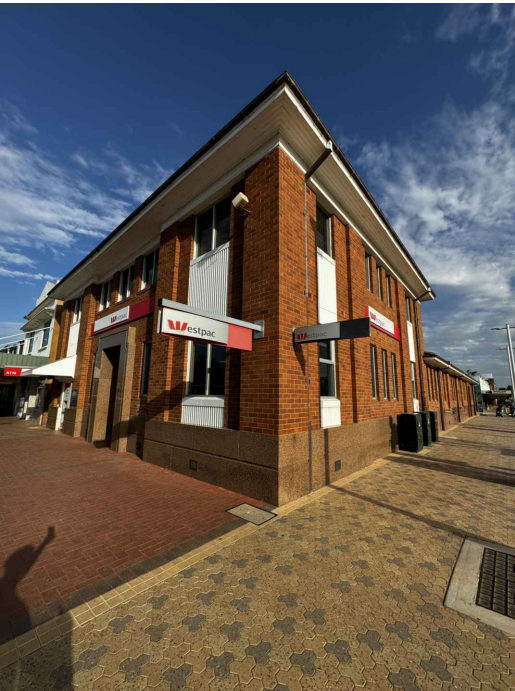

WESTPAC + ST GEORGE GRIFFITH
242 BANNA AVENUE
GRIFFITH, NSW 2680

DEVELOPMENT APPLICATION
ARCHITECTURAL DRAWINGS

- DA00 COVER PAGE, LOCATION MAP
- DA01 PROPOSED - GROUND FLOOR PLAN & SCHEDULE OF SIGNAGE
- DA02 PROPOSED SHOPFRONT ELEVATION & SCHEDULE OF SIGNAGE



SITE PHOTOS



LOCATION MAP



NOTE: CONTRACTOR TO CHECK ALL DIMENSIONS ON SITE PRIOR TO COMMENCING CONSTRUCTION. DO NOT SCALE FROM THIS DRAWING.

BRAND	PROJECT MANAGER		ARCHITECT		REVISIONS		DRAWN	PROPERTY ID	PROJECT NO	PROJECT	WESTPAC + ST. GEORGE GRIFFITH
					Rev.	Date	Description	By	SM	TBC	W24034
					MANAGER		PROJECT ID	DRAWING NO	DRAWING	COVER PAGE, LOCATION MAP, & PHOTOS DEVELOPMENT APPLICATION	
					AI	TBC	DA00				
PROJECT MANAGER		ARCHITECT		REVISIONS		BRANCH BSB	PJT COMMENCEMENT DATE	SCALE	N.T.S @ A3		
				A		TBC	MAY 2024				

LEGEND		SCHEDULE OF SIGNAGE			
#	REFER TO CORRESPONDING SIGNAGE REFERENCE IN SIGNAGE SCHEDULE FOR DETAIL AND SPECIFICATION	NO.	SIGNAGE / GRAPHIC NAME: INTERNALLY ILLUMINATED SIGN	AREA	DIMENSIONS
	OUT OF SCOPE	1.	COLO CANTILEVER SIGNAGE.	0.64m²	1800mm (W) x 360mm (H)
		2.	COLO CANTILEVER SIGNAGE.	0.64m²	1800mm (W) x 360mm (H)
		3.	FASCIA PANEL SIGNAGE	3.6m²	6000mm (W) x 600mm (H)
		4.	ATM WAL SIGNAGE.	2.46m²	1000mm (W) x 2287mm (H)
		5.	COLO CANTILEVER SIGNAGE.	0.64m²	1800mm (W) x 360mm (H)
NOTES		DESCRIPTIONS:			
- ALL SIGNAGE IS TO COMPLY WITH RELEVANT CONTROLS OF SECTION 3 (ADVERTISEMENT AND ROAD SAFETY) OF THE NSW DEPARTMENT OF PLANNING AND ENVIRONMENT TRANSPORT, CORRIDOR OUTDOOR ADVERTISING AND SIGNAGE GUIDELINES NOVEMBER 2017.		ILLUMINATION HOURS: 7am To 10pm			
- ILLUMINATED SIGNAGE ELEMENTS TO BE INSTALLED IN ACCORDANCE WITH AUSTRALIAN STANDARD (AS4282:1997) CONTROL OF OBTRUSIVE EFFECTS OF OUTDOOR LIGHTING.		INTERNALLY ILLUMINATED WESTPAC HERO_W LOGO SIGNAGE INSTALLED AT CENTRE OF EXISTING LOUVRE STRUCTURE			
		ALPOLIC NC "WHITE/ANTHRACITE GREY" FASCIA PANEL WITH COLO LOGOS. ILLUMINATION TO LOGOS ONLY.			
		NEW DN250 MACHINE AND ATM SURROUND OVER ACM.			
		ALPOLIC NC "ANTHRACITE GREY" FINISH OVER ATM WALL, ROLLED EDGES AROUND ATM.			

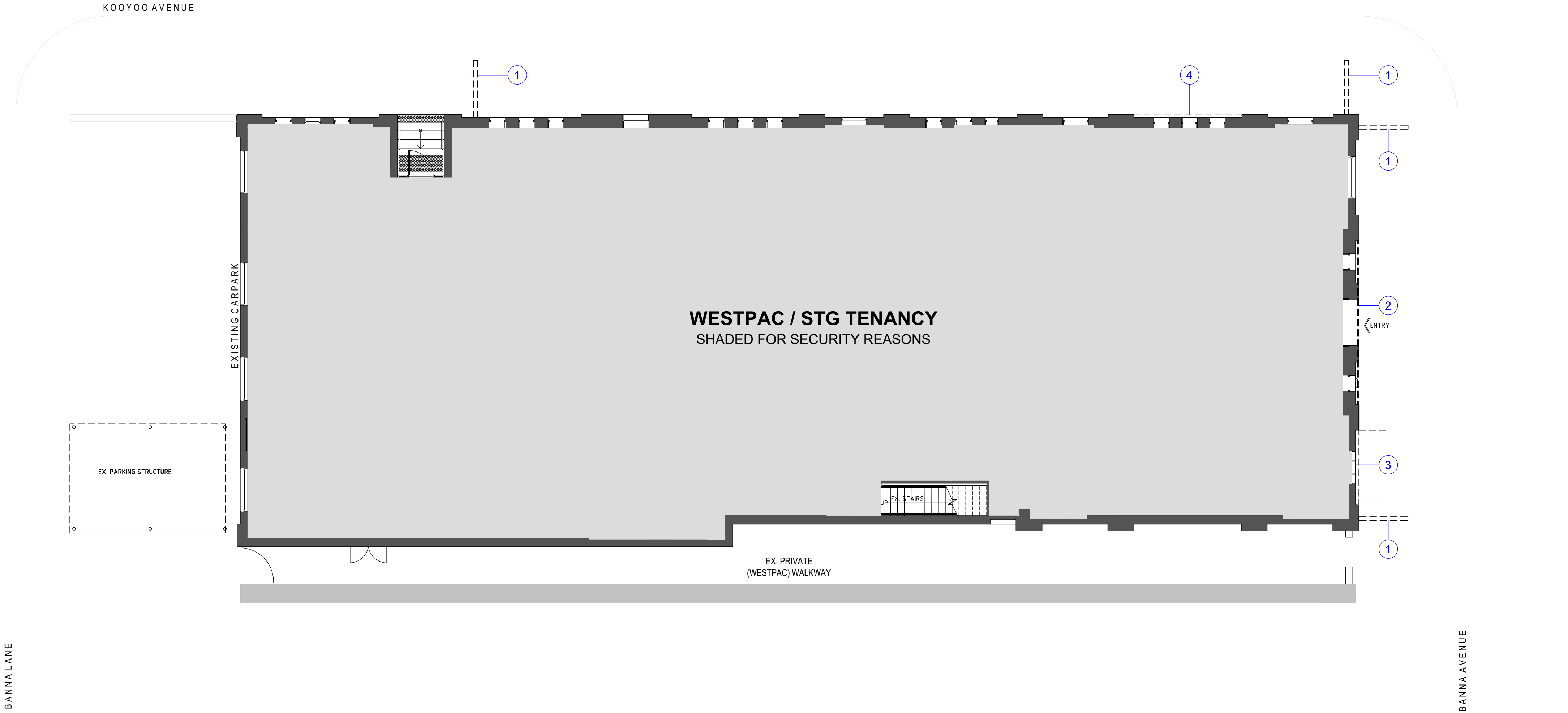

BRAND



PROJECT MANAGER



ARCHITECT



REVISIONS

Rev	Date	Description	By
A	20/09/24	DEVELOPMENT APPLICATION ISSUE	SM

DRAWN

SBY

PROPERTY ID

TBC

PROJECT NO

W24034

PROJECT

CO-LOCATION WESTPAC & ST GEORGE
242 BANNA AVENUE
GRIFFITH NSW 2680

MANAGER

AI

PROJECT ID

TBC

DRAWING NO

DA01

DRAWING

PROPOSED - GROUND FLOOR PLAN
DEVELOPMENT APPLICATION

REVISION

A

BRANCH BSB

TBC

PJT COMMENCEMENT DATE

MAY 2024

SCALE

1:100 @ A2 SIZE

NOTE: CONTRACTOR TO CHECK ALL DIMENSIONS ON SITE PRIOR TO COMMENCING CONSTRUCTION. DO NOT SCALE FROM THIS DRAWING.



LEGEND		SCHEDULE OF SIGNAGE				
<div>#</div>	REFER TO CORRESPONDING SIGNAGE REFERENCE IN SIGNAGE SCHEDULE FOR DETAIL AND SPECIFICATION	NO.	SIGNAGE / GRAPHIC NAME <u>INTERNALLY ILLUMINATED SIGN</u>	AREA	DIMENSIONS	DESCRIPTIONS <u>ILLUMINATION HOURS: 7am To 11pm</u>
<div></div>	OUT OF SCOPE	1	COLO CANTILEVER SIGNAGE.	0.70m²	1950mm (W) x 360mm (H)	INTERNALLY ILLUMINATED COLO BRANDS LOGO SIGNAGE ON EXTERNAL WALL
NOTES	<div>- ALL SIGNAGE IS TO COMPLY WITH RELEVANT CONTROLS OF SECTION 3 (ADVERTISEMENT AND ROAD SAFETY) OF THE NSW DEPARTMENT OF PLANNING AND ENVIRONMENT TRANSPORT, CORRIDOR OUTDOOR ADVERTISING AND SIGNAGE GUIDELINES (NOVEMBER 2017).</div> <div>- ILLUMINATED SIGNAGE ELEMENTS TO BE INSTALLED IN ACCORDANCE WITH AUSTRALIAN STANDARD (AS4282:1997) CONTROL OF OBTRUSIVE EFFECTS OF OUTDOOR LIGHTING.</div>	2	FASCIA PANEL SIGNAGE	3.60m²	6000mm (W) x 600mm (H)	ALPOLIC NC "WHITE/ANTHRACITE GREY" FASCIA PANEL WITH COLO LOGOS. ILLUMINATION TO LOGOS ONLY
		3	ATM WAL SIGNAGE.	2.46m²	1080mm (W) x 2287mm (H)	NEW DN250 MACHINE AND ATM SURROUND OVER ACM.
		4	FASCIA PANEL SIGNAGE	2.36m²	3945mm (W) x 600mm (H)	ALPOLIC NC "WHITE/ANTHRACITE GREY" FASCIA PANEL WITH COLO LOGOS. ILLUMINATION TO LOGOS ONLY.

NOTE: CONTRACTOR TO CHECK ALL DIMENSIONS ON SITE PRIOR TO COMMENCING CONSTRUCTION. DO NOT SCALE FROM THIS DRAWING.



MostynCopper

95 Pitt Street Sydney
T 02 9241 1699
W mostyncopper.com.au



Level 1, 121 Alexander Street
Crows Nest NSW 2065
T 02 9901 4422 F 02 9901 4466
E admin@rfaarchitects.com.au

Rev.	Date	Description	By
A	20/09/24	DEVELOPMENT APPLICATION ISSUE	SM

SBY

MANAGER
AI

A

TBC

PROJ
TBC

BRANCH BSB

TBC

W24034

DRAWING NO

PJT COMMENCEMENT DATE

MAY 2024

242 BANNA AVENUE
GRIFFITH NSW 2680

DRAWING

SCALE

CO-LOCATION WESTPAC & ST GEORGE
242 BANNA AVENUE
GRIFFITH NSW 2680

SHOPFRONT ELEVATION DEVELOPMENT APPLICATION

1:100 @ A2 SIZE